

(LAKE GEORGE NE,  
CO)



105° 14' 55.10" W  
038° 53' 31.12" N +

(DIVIDE NW, CO)

DIVIDE SW, CO QUADRANGLE

COLORADO  
AERIAL PHOTO SERIES

(DIVIDE NE, CO)

105° 14' 28.61" W  
+ 038° 53' 31.12" N

**Sketch by  
Gunter Ott  
719-687-1552**

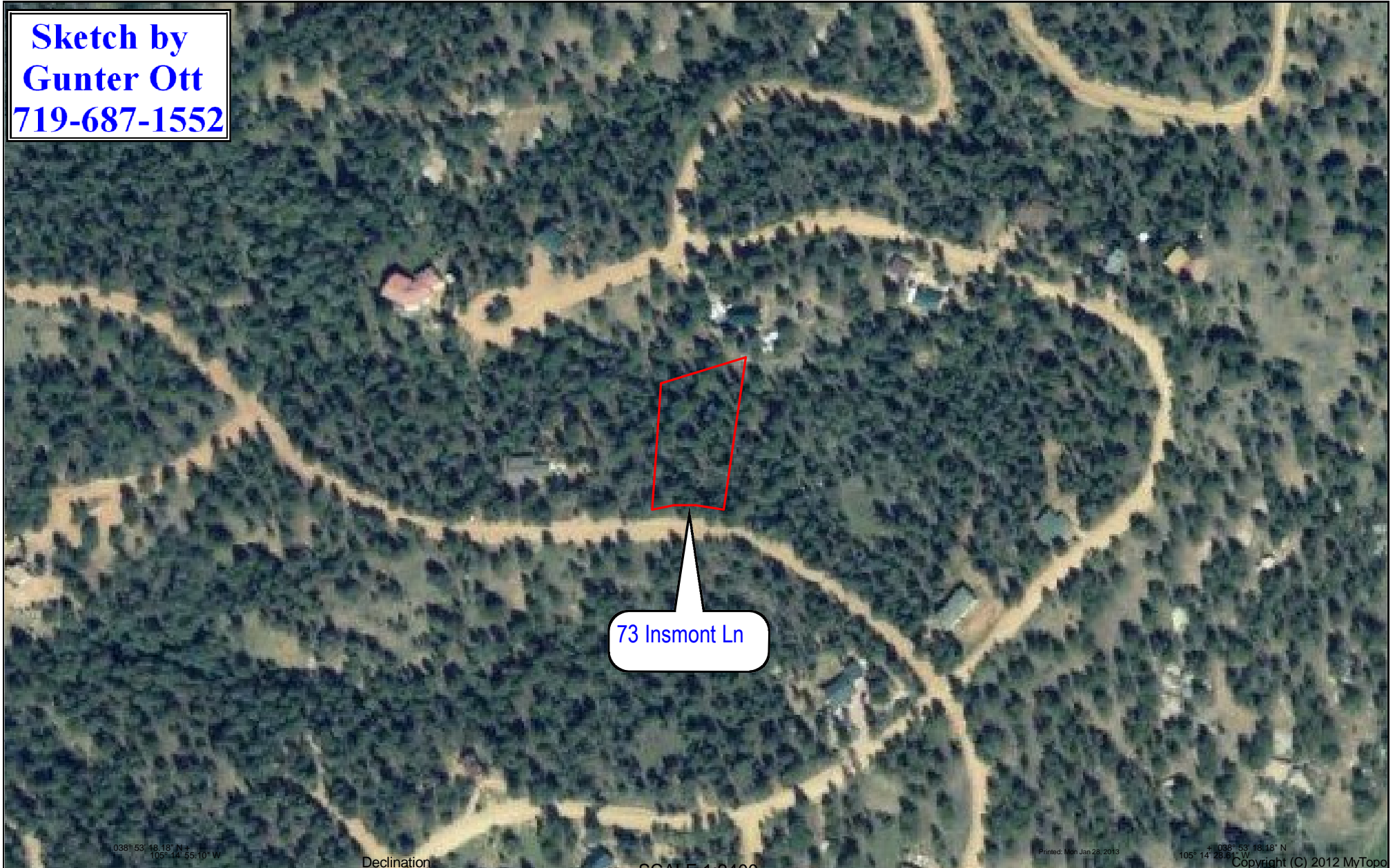

73 Insmont Ln

038° 53' 18.18" N +  
105° 14' 55.10" W

Printed: Mon Jan 28, 2013

+ 038° 53' 18.18" N  
105° 14' 28.61" W

Copyright (C) 2012 MyTopo

(WRIGHTS RESERVOIR NE,  
CO)

Produced by MyTopo Terrain Navigator  
Topography based on USGS 1:12,000 Maps

North American 1983 Datum (NAD83)  
Universal Transverse Mercator Projection

To place on the predicted North American 1927 move the  
meridian lines 1M S and 47M W

Declination



GN 0.15° W  
MN 8.77° E

SCALE 1:2400

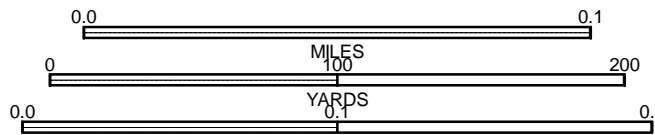

CONTOUR INTERVAL UNKNOWN NONE  
NATIONAL GEODETIC VERTICAL DATUM 1929

(CRIPPLE CREEK  
NORTH NE, CO)

DIVIDE SW, CO, CO  
SEP 4, 2011